

# Specification Sheet for FC500 Range

Company Name: \_\_\_\_\_ Date: \_\_\_\_\_

Order Number: \_\_\_\_\_ Quantity required: \_\_\_\_\_

☐ Deliver Lift ☐ Collect Lift from Del Delivery Date Required: \_\_\_\_\_

## Delivery Address

Company Name: \_\_\_\_\_ Street Address: \_\_\_\_\_

Post Code: \_\_\_\_\_ City: \_\_\_\_\_

## Vehicle Details

☐ Rigid

### Vehicle Type:

☐ Box Van ☐ Curtainsider

Vehicle Make & Model: \_\_\_\_\_

Chassis Mass: \_\_\_\_\_

### For Dimensions Information, see Sheet 4.

Dimension A (Floor Height): \_\_\_\_\_ mm

Dimension L (Distance from Vehicle floor to the top of the lift roof): \_\_\_\_\_ mm

Dimension W (Width over Panels): \_\_\_\_\_ mm

### Please select W (Width over Panels) size below:

☐ 2065mm ☐ 2075mm ☐ 2085mm ☐ 2090mm ☐ 2100mm ☐ 2130mm

☐ 2150mm ☐ 2170mm ☐ 2190mm ☐ 2200mm ☐ 2235mm ☐ 2250mm

### Vehicle Voltage:

☐ 12v ☐ 24v

## Tail Lift Details

### Lift Capacity:

☐ 500kg

### Platform Working Area:

☐ 42" (1065mm) ☐ 46" (1168mm) ☐ 54" (1370mm)

### Rear Ramp Type:

☐ 8" (205mm) Fixed Leading Edge (Trolley Stops standard)

### Control Setup:

☐ Dual Fixed Controls ☐ Single External Wanderlead ☐ Internal Hard Wired Wanderlead and External Fixed Control

### Tail Lift Isolator:

☐ Cab Switch **(Not required if you have Single Detachable Wanderlead).**

### Cable Options:

☐ 27' Battery Cables (Standard) ☐ 35' Battery Cables ☐ Plug & Play Kit **(Please see page 3 for details)**

### Fence Type:

☐ N/S Drop Down Fence & O/S Auto Erect Fence ☐ O/S Drop Down Fence N/S Auto Erect Fence ☐ Pair of Drop Down Fences  
☐ Pair of Auto Erect Fences ☐ Pair of Drop in Fences  
☐ Single Drop in Fence ☐ Sockets only for Drop in Fences

### Options:

☐ Low Floor Application (Bed Heights lower than 800mm) ☐ Battery Guard ☐ Stow Light Indicator  
☐ Left Hand Drive ☐ Service Kit  
☐ 2 Year Warranty ☐ 3 Year Warranty ☐ 4 Year Warranty ☐ 5 Year Warranty

## To be completed by DEL

Part Number of Lift: \_\_\_\_\_

Price of each Lift: \_\_\_\_\_

**Plug & Play Kit Options:**

☐ Plug & Play Kit to be supplied with the Lift    ☐ Plug & Play Kit sent in advance (£15 extra charge).

☐ Option 1 – Plug & Play on Power, Earth & 2-Core Only.

**Cables attached to the Tail Lift Power Pack/ Beam:**

1800mm CABLE FOR CAB SWITCH WITH PLUG  
2000mm BATTERY CABLES WITH PLUG

**Kit Box sent in advance includes:**

21' POWER CABLE (WIRED TO ANDERSON PLUG)  
WIRED TO 200A MEGA FUSE  
21' EARTH CABLE (WIRED TO ANDERSON PLUG)  
30' 2 CORE FOR CAB SWITCH WITH CONNECTOR  
CAB SWITCH KIT

☐ Option 2 – Plug & Play on Power, Earth, 2 Core & cable for Internal Control. **(Ext Control pre-wired as standard).**

**Cables attached to the Tail Lift Power Pack/ Beam:**

400mm 4 CORE CABLE WITH PLUG  
1300mm 4 CORE CABLE WIRED TO CONTROL  
CAB SWITCH  
1800mm CABLE FOR CAB SWITCH WITH PLUG  
2000mm BATTERY CABLES WITH PLUG

**Kit Box sent in advance includes:**

21' POWER CABLE (WIRED TO ANDERSON PLUG)  
WIRED TO 200A MEGA FUSE  
21' EARTH CABLE (WIRED TO ANDERSON PLUG)  
30' 2 CORE FOR CAB SWITCH WITH CONNECTOR  
CAB SWITCH KIT

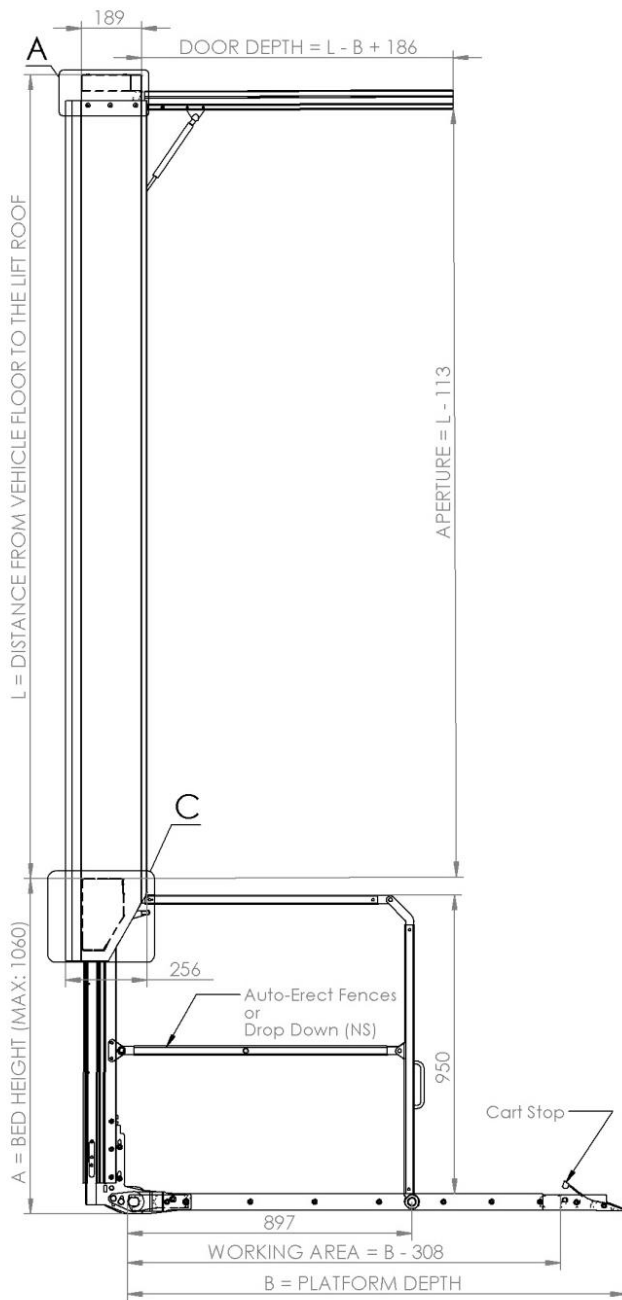

DETAIL A

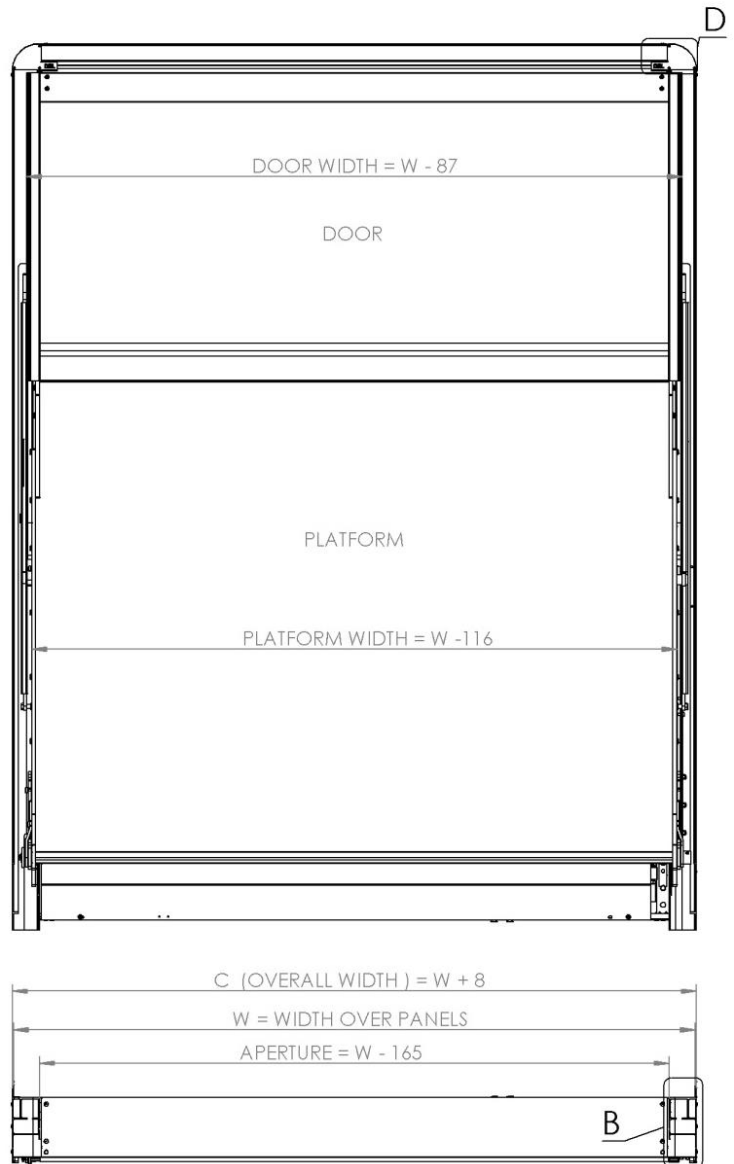

DETAIL B

DETAIL C

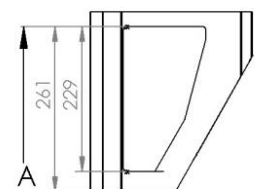
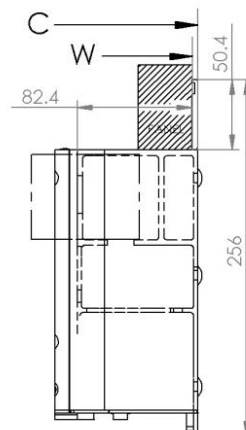
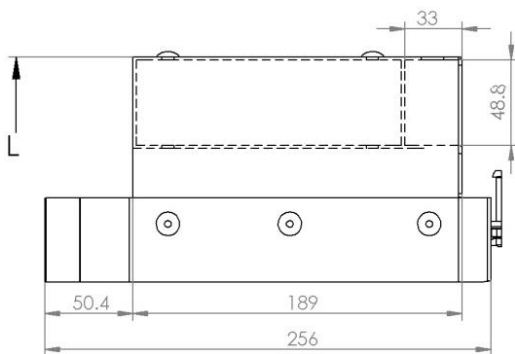

DETAIL D

